



**AVAILABLE**

# Sunnyside Plaza

929 Worcester Street | Natick, MA





# Sunnyside Plaza

929 Worcester Street | Natick, MA



2,206 SF End Cap  
Available

Brian Nadler  
Chloe Glennon  
Contact Broker

## DESCRIPTION

- Sunnyside Plaza is strategically located at 915-947 Worcester Street in Natick, on Route 9 (westbound side) at the intersection with Route 27.
- Tenants include ATI Physical Therapy, AFC Urgent Care, H&R Block, Tama, Square Pizza, Vanity Fur, and Primula.
- Sunnyside Plaza provides easy egress and ingress off Rt 9, with tremendous traffic counts, and desirable demographics where Rt 9 & Rt 27 meet.
- Highly visible with exceptional access to Metro-West Demographics.

## CURRENT TENANTS

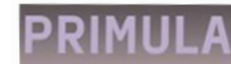

## TRAFFIC COUNTS

Worcester Street, adjacent to Site VPD  
Worcester Street, W of Site  
Year: 2019 | Source: massDOT

55,392 VPD  
107,508 VPD

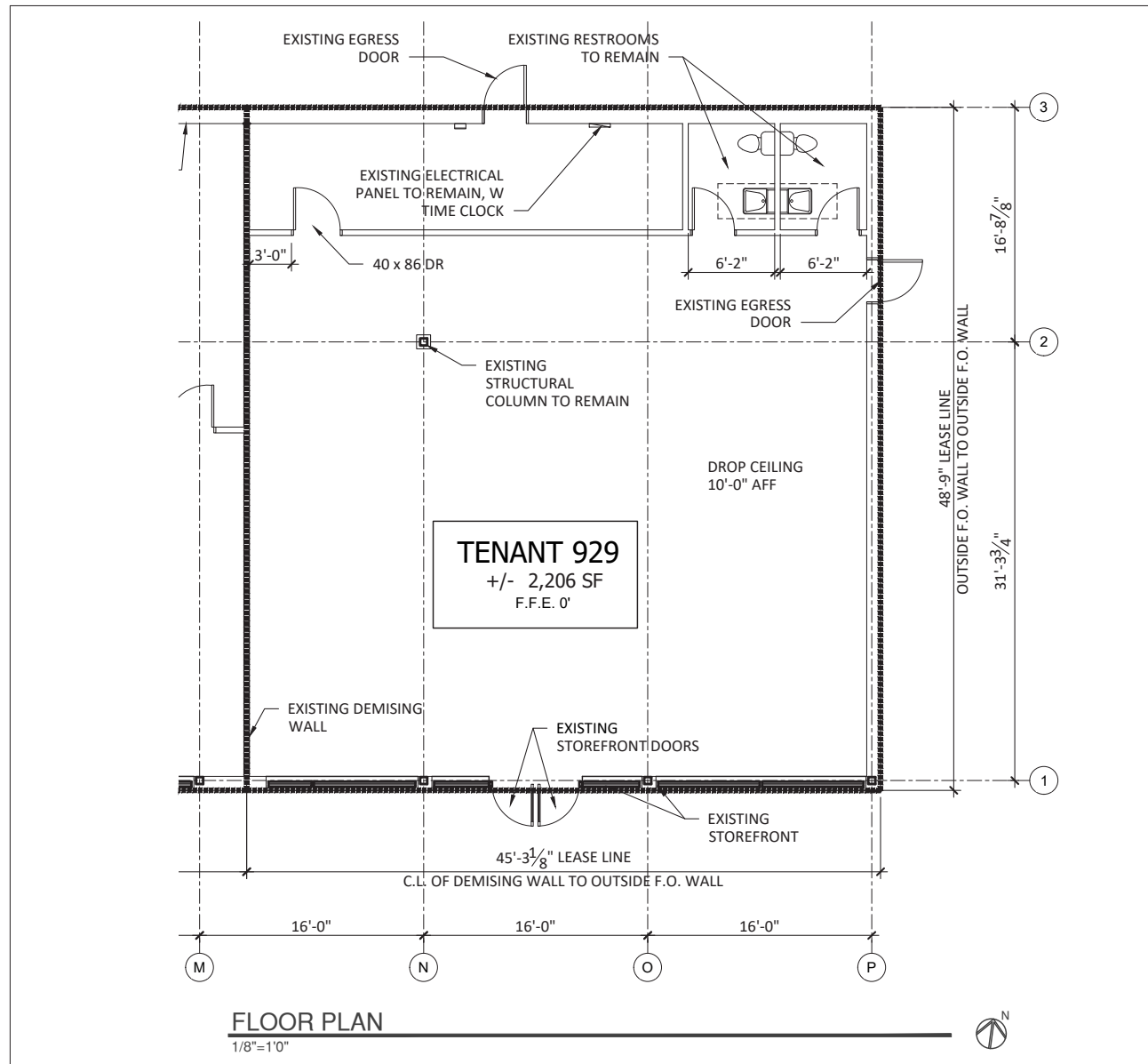







# Sunnyside Plaza

929 Worcester Street | Natick, MA



## DEMOGRAPHIC HIGHLIGHTS

### Population

	1 mile	3 miles	5 miles
2022 Estimated Population	8,339	77,895	150,792
2027 Projected Population	8,265	77,320	150,724
Projected Annual Growth Rate 2022 to 2027	-0.18%	-0.15%	-0.01%

### Daytime Population

	1 mile	3 miles	5 miles
2022 Daytime Population	9,991	87,086	162,084
Workers	6,402	51,617	90,546
Residents	3,589	35,469	71,538

### Income

	1 mile	3 miles	5 miles
2022 Est. Average Household Income	\$183,089	\$172,731	\$189,333
2022 Est. Median Household Income	\$135,294	\$120,155	\$128,527

### Households & Growth

	1 mile	3 miles	5 miles
2022 Estimated Households	3,231	29,569	54,739
2027 Estimated Households	3,200	29,250	54,567
Projected Annual Growth Rate 2022 to 2027	-0.19%	-0.22%	-0.06%

### Race & Ethnicity

	1 mile	3 miles	5 miles
2022 Est. White	77%	65%	66%
2022 Est. Black or African American	3%	4%	4%
2022 Est. Asian or Pacific Islander	11%	12%	10%
2022 Est. American Indian or Native Alaskan	0%	0%	0%
2022 Est. Other Races	2%	9%	9%
2022 Est. Hispanic	5%	11%	11%

> **Want more?** Contact us for a complete demographic, foot-traffic, and mobile data insights report.

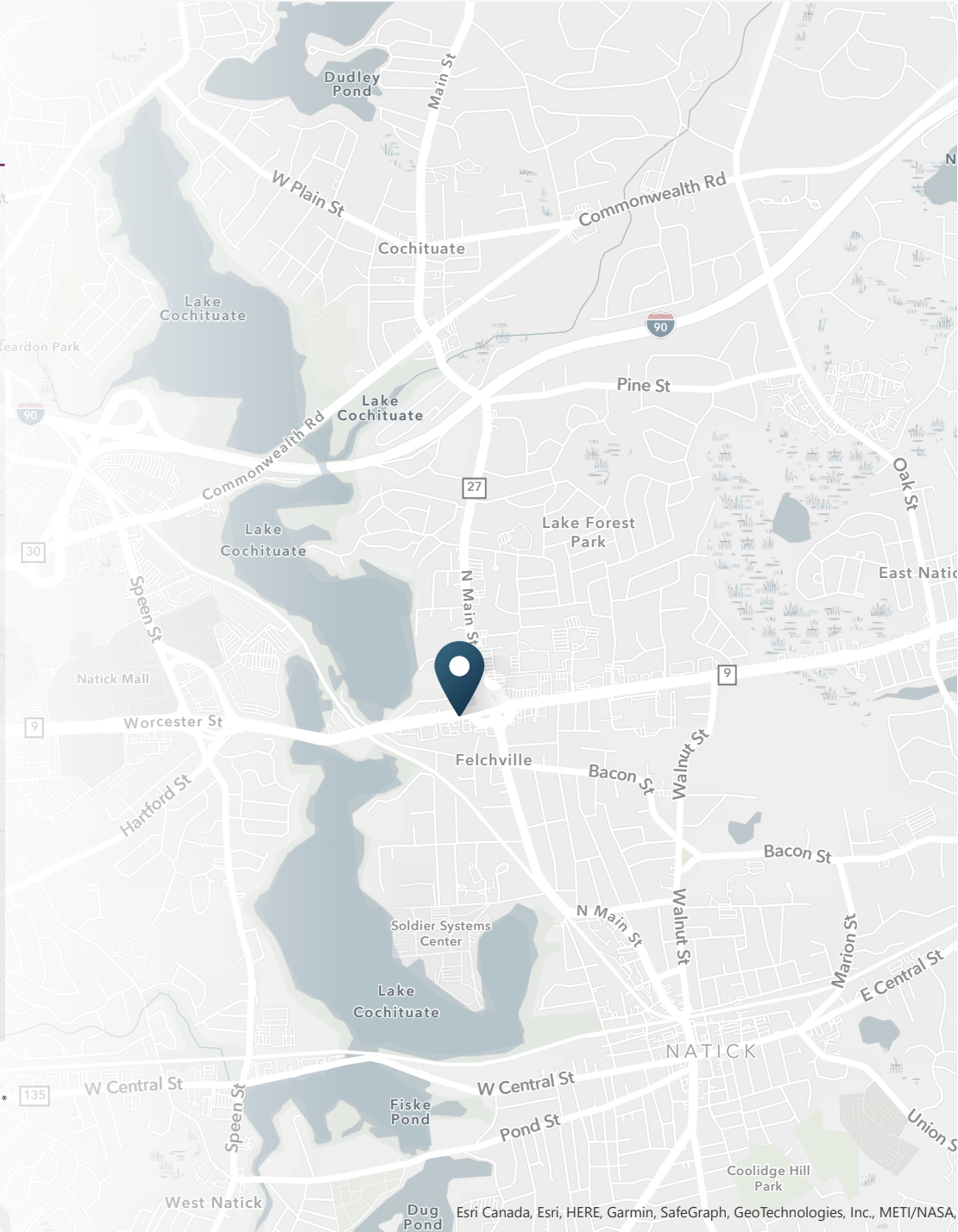





**SRS Real Estate Partners**  
400 Fifth Avenue, Suite 105  
Waltham, MA 02451  
857.263.3839

**Brian Nadler**  
617.665.7395  
Brian.Nadler@srsre.com

**Chloe Glennon**  
781.733.1052  
Chloe.Glennon@srsre.com

**Jonathan Lapat**  
**Broker of Record**

**SRSRE.COM**

© SRS Real Estate Partners

The information presented was obtained from sources deemed reliable;  
however SRS Real Estate Partners does not guarantee its completeness or accuracy.